

LED Roadway Lighting Luminaire SPECIFICATION (3000K@480V)

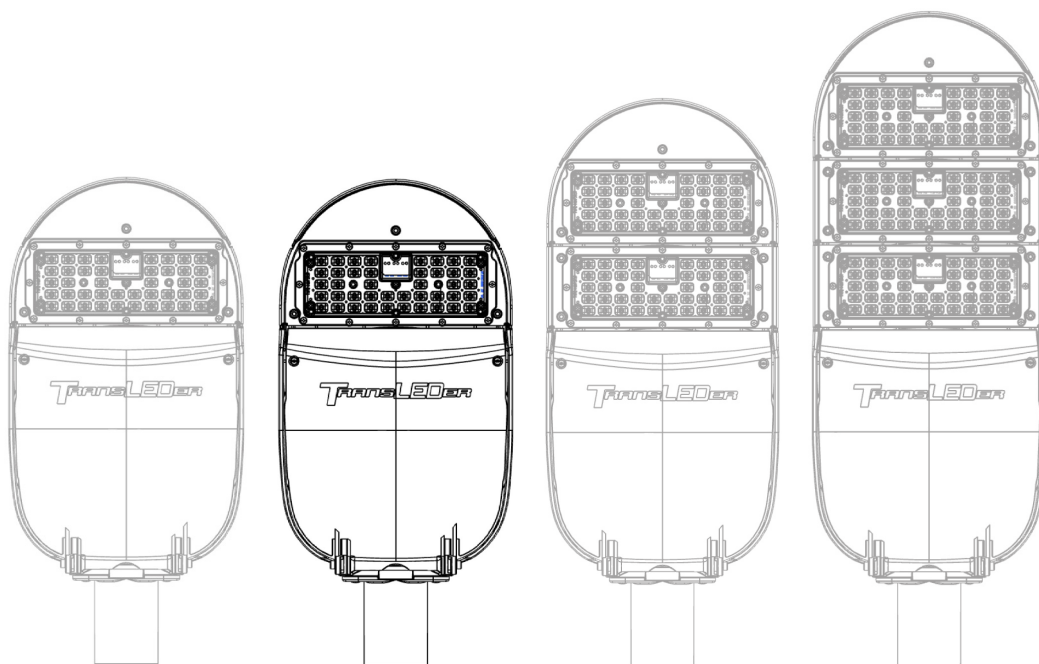

ORDER GUIDE

Group	TL	UUU	VV	WW	XX	Y	ZZ
Example	RL	070	5M	WW	UH	D	BZ

Group	Description																
RL	Represents LED Roadway Lighting ;																
UUU	Represents input power, which can be 040, 070, 100, 110, 190, 210, 265, 335 or others, e.g., 070= 70 W ;																
VV	Represents lens type, distinguished by different models, which can be 2M, 3M, 4M, 4S, 5M, 5S, or others. <table border="0"> <tr> <td>Type II (Full Cutoff)</td> <td>2S (Short);</td> <td>2M (Medium)*;</td> <td>2L (Long);</td> </tr> <tr> <td>Type III (Full Cutoff)</td> <td>3S (Short);</td> <td>3M (Medium)*;</td> <td>3L (Long);</td> </tr> <tr> <td>Type IV (Full Cutoff)</td> <td>4S (Short);</td> <td>4M (Medium)*;</td> <td>4L (Long);</td> </tr> <tr> <td>Type VS (Full Cutoff)</td> <td>5S (Short);</td> <td>5M (Medium)*;</td> <td>5L (Long).</td> </tr> </table>	Type II (Full Cutoff)	2S (Short);	2M (Medium)* ;	2L (Long);	Type III (Full Cutoff)	3S (Short);	3M (Medium)* ;	3L (Long);	Type IV (Full Cutoff)	4S (Short);	4M (Medium)* ;	4L (Long);	Type VS (Full Cutoff)	5S (Short);	5M (Medium)* ;	5L (Long).
Type II (Full Cutoff)	2S (Short);	2M (Medium)* ;	2L (Long);														
Type III (Full Cutoff)	3S (Short);	3M (Medium)* ;	3L (Long);														
Type IV (Full Cutoff)	4S (Short);	4M (Medium)* ;	4L (Long);														
Type VS (Full Cutoff)	5S (Short);	5M (Medium)* ;	5L (Long).														
WW	Represents the nominal Correlated Color Temperature, which can be <table border="0"> <tr> <td>CW</td> <td>Cool White</td> <td>5000 K (± 300 K);</td> </tr> <tr> <td>NW</td> <td>Neutral White</td> <td>4000 K (± 300 K);</td> </tr> <tr> <td>WW</td> <td>Warm White</td> <td>3000 K (± 300 K)^{+ *};</td> </tr> </table>	CW	Cool White	5000 K (± 300 K);	NW	Neutral White	4000 K (± 300 K);	WW	Warm White	3000 K (± 300 K)^{+ *} ;							
CW	Cool White	5000 K (± 300 K);															
NW	Neutral White	4000 K (± 300 K);															
WW	Warm White	3000 K (± 300 K)^{+ *} ;															
XX	Represents the input voltage: UL (120-277V)* , or UH (480V).																
Y	Represents the dimming function, D (DALI)* , or P (Photocell).																
ZZ	Represents the luminaire body color, which can be BK, BZ, GN, GY or WT <table border="0"> <tr> <td>BK</td> <td>Black</td> <td>(RAL 9017);</td> </tr> <tr> <td>BZ</td> <td>Bronze</td> <td>(RAL 8019)*;</td> </tr> <tr> <td>GN</td> <td>Green</td> <td>(RAL 6005);</td> </tr> <tr> <td>GY</td> <td>Gray</td> <td>(RAL 7038);</td> </tr> <tr> <td>WT</td> <td>White</td> <td>(RAL 9010).</td> </tr> </table>	BK	Black	(RAL 9017);	BZ	Bronze	(RAL 8019)* ;	GN	Green	(RAL 6005);	GY	Gray	(RAL 7038);	WT	White	(RAL 9010).	
BK	Black	(RAL 9017);															
BZ	Bronze	(RAL 8019)* ;															
GN	Green	(RAL 6005);															
GY	Gray	(RAL 7038);															
WT	White	(RAL 9010).															

* Featured products.

+ Warm-toned LED light sources (3000K or lower) must be selected to meet the International Dark-Sky Association dark sky requirements.

CERTIFICATIONS

SAFETY	Luminaires [UL 1598:2021 Ed.5]	Certified
SAFETY	Luminaires [CSA C22.2 No. 250.0:2021 Ed.5]	Certified
FCC	FCC Part 15 Subpart B; ANSI C63.4a-2017	Certified
DIELECTRIC WITHSTAND AND ELECTRICAL TRANSIENT IMMUNITY	C136.2-2015: Clause 6, Clause 7, 7.1, 7.2, 7.3, 7.4	Certified
INGRESS PROTECTION	Ingress protection	IP65
THD	Max. Total Harmonic Distortion (%)	20
IMPACT TEST	Resistance to external mechanical impact test	IK10
SALINE MIST TEST	Salt spray test to ISO 9227	1,000 hours
RoHS COMPLIANCE	European Directive 2011/65/EC	Certified

SPECIFICATION

RL-070-VV-WW-UH-D-BZ (One-Module)

VOLTAGE	Nominal luminaire input voltage range	480 V
INPUT POWER	Nominal luminaire input power	70.1 W ‡
LUMINAIRE OUTPUT	Nominal luminaire luminous flux output	9700 lm ‡
EFFICACY	Nominal luminaire efficacy	138.4 lm/W ‡
POWER FACTOR	Min. power factor	0.99‡
LUMEN MAINTENANCE	Min. % of the initial output at 100,000 hours of operation	L95.6
• L90	Estimated time reaching 90% of the initial luminous flux	> 102,000 hours
• L80	Estimated time reaching 80% of the initial luminous flux	> 102,000 hours
• L70	Estimated time reaching 70% of the initial luminous flux	> 102,000 hours
LMF	Luminaire maintenance factor used for simulation	0.80
CHROMATICITY SHIFT	LED chromaticity shift at 7,000 hours of operation	0.0015 Δu'v'
NOMINAL CCT	Nominal correlated color temperature	3000 K
CRI	Color Rendering Index	> 70
WEIGHT	Max. luminaire weight	15.3 lbs.
DIMENSION	L x W x H	24.3" x 11.7" x 5.8"
SAIL AREA	Max. effective sail area	0.59 ft ²
TERMINAL BLOCK GAUGE	6-Way Screw Down Terminal Blocks Wire Gauges	#14 AWG - #6 AWG
PCR	Photoelectric Control Receptacle	Rotatable
OPTICAL DISTRIBUTION	<input type="checkbox"/> Type II <input checked="" type="checkbox"/> Type III <input checked="" type="checkbox"/> Type IV <input checked="" type="checkbox"/> Type V	
MOUNTING SLIP FITTER	<input checked="" type="checkbox"/> Top-entry <input checked="" type="checkbox"/> Side-entry <input checked="" type="checkbox"/> Integral tilt (-10° to +10°)	
	Nominal Pole Size (NPS)	1.25"/2" NPS
VIBRATION	ANSI C136.31 <input type="checkbox"/> Level 1 (normal) <input checked="" type="checkbox"/> Level 2 (bridge/overpass)	
THERMAL ENVIRONMENT	Typical min. ambient temperature during operation	-40 °C (-40 °F)
	Typical max. ambient temperature during operation	+40 °C (+104 °F)
SURGE PROTECTION DEVICE	ANSI C136.2 <input type="checkbox"/> Basic (6kV/3kA) <input checked="" type="checkbox"/> Enhanced (10kV/5kA) <input type="checkbox"/> Elevated, (20kV/10kA)	
CONTROL INTERFACE	<input type="checkbox"/> None <input type="checkbox"/> ANSI C136.10 3-pin <input type="checkbox"/> ANSI C136.41 5-pin <input checked="" type="checkbox"/> ANSI C136.41 7-pin	
LED DRIVER	<input type="checkbox"/> Not Dimmable <input type="checkbox"/> Dimmable, 0-10V (IEC 60929) <input checked="" type="checkbox"/> Dimmable DALI-2, D4i, NFC	

‡ Values shown are subject to ±5% tolerance.

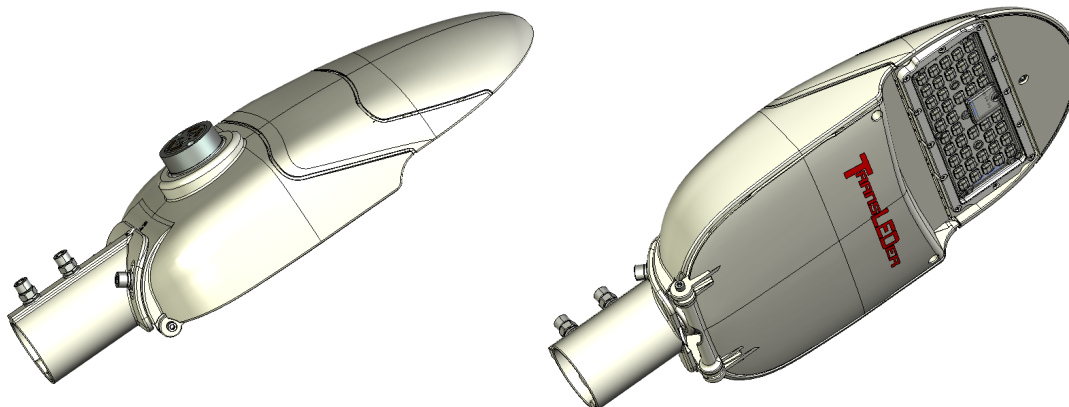

PHOTOMETRY

Type III Medium Full Cutoff

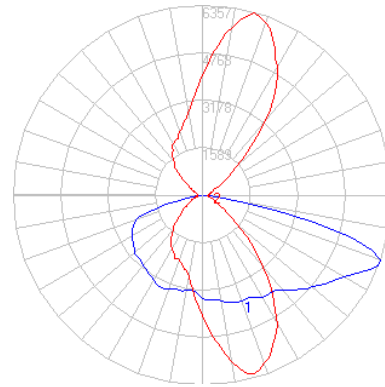
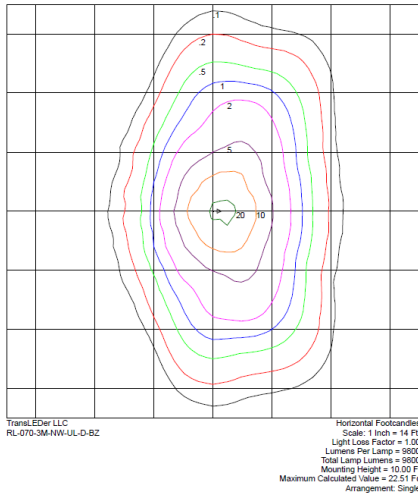

Type IV Medium Full Cutoff

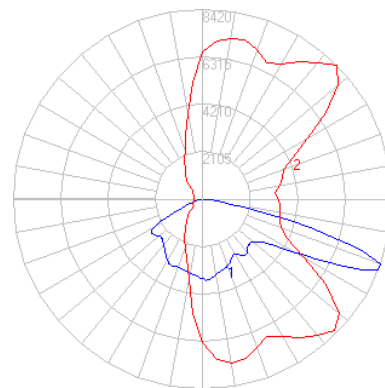
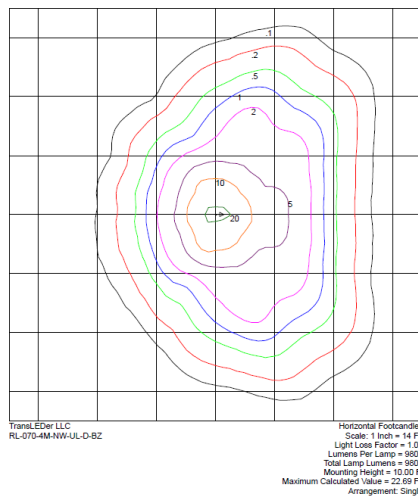

Type V Medium Full Cutoff

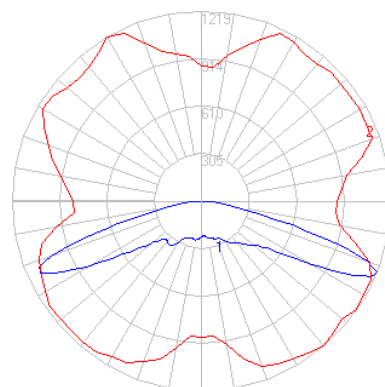
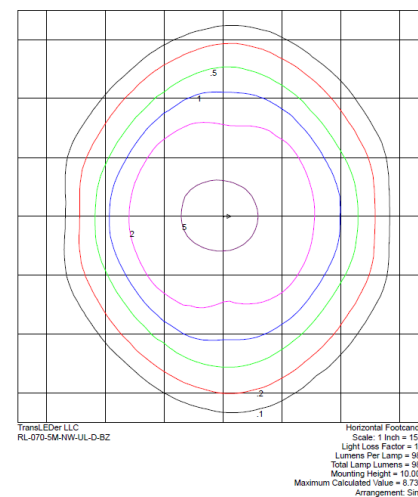

DIMENSIONS

1-Module Model

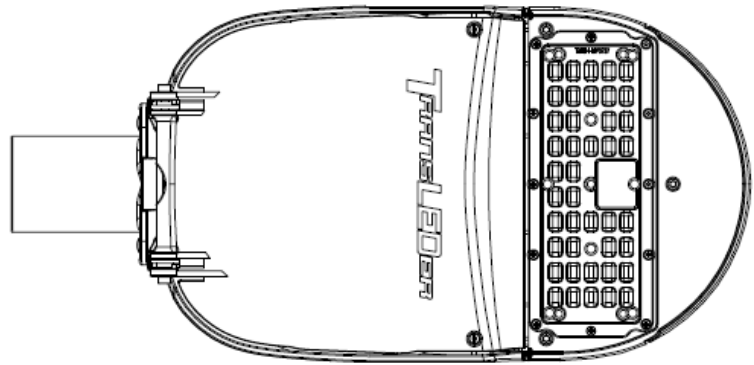
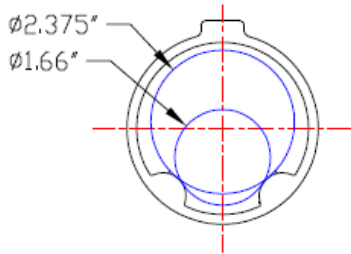
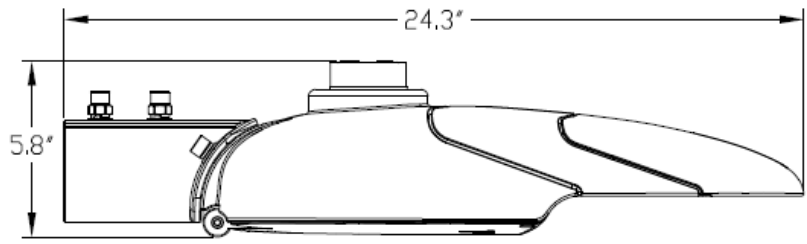
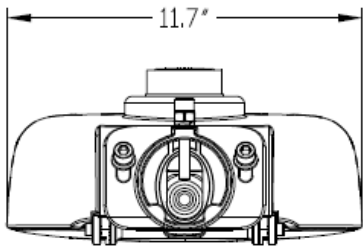

FEATURES

